

Menara Mesiniaga

1-A, Jalan SS16/1, Subang Jaya
Selangor Darul Ehsan, Malaysia

Architect T. R. Hamzah & Yeang Sdn. Bhd.
Kenneth Yeang
Ampang - Selangor, Malaysia

Client Mesiniaga Sdn. Bhd.
Selangor Darul Ehsan, Malaysia

Commission December 1989

Design December 1989

Construction December 1990

Occupancy December 1992

Site 4720 m²

Ground Floor 791 m²

Total Floor 11210 m²

Costs

- Global 8500000 USD

23000000 MYR

Rate USD = 2.70 MYR (Mar. '94)

- per m² 759 USD

2050 MYR

Rate USD = 2.70 MYR (Mar. '94)

Currency Malaysian Ringgits

Programme A commercial office building featuring "vertical landscaping" and a number of passive low-energy features adapted to the tropical climate.

Building Type

322

1995 Award Cycle

1356.MAL



1356.MAL MENARA MESINIAGA, Selangor

The building exemplifies the bioclimatic approach to design applied to the design of tall buildings. In particular, the building has the following features:

- "Vertical Landscaping" (planting) is introduced into the building facade and at the "skycourts". In this building the planting starts by mounding up from ground level to as far up as possible at one side of the building. The planting then "spirals" upwards with the use of recessed terraces (as skycourts) at the faces of the building heading towards the upper floor.

- A number of passive low-energy features are also incorporated: All the window areas facing the hot sides of the building (i.e. east and west sides) have external louvres as solar-shading to reduce solar heat gain into the internal spaces. Those sides without direct solar insolation (i.e. the north and south sides) have curtain-walled glazing for views as well as to give the user opportunities for natural ventilation.

- The lift lobbies at all floors are naturally ventilated and are sunlit with views to the outside. These do not require fire-protection pressurisation of the lobbies (i.e. low-energy lobby). All stairways and toilet areas are also naturally ventilated and have natural sunlight.

- The sunroof provides panel space for the possible future placement of solar-cells to provide background sources of energy. BAS (Building Automation Systems) and other intelligent Building features are used to reduce energy consumption in the building operating and in the air-conditioning system.

Architect:
T. R. Hamzah & Yeang Sdn. Bhd.
8, Jalan 1, Taman Sri Uday, 68000 Ampang
Selangor Tel: (03)4571956 Fax: (03)4561005

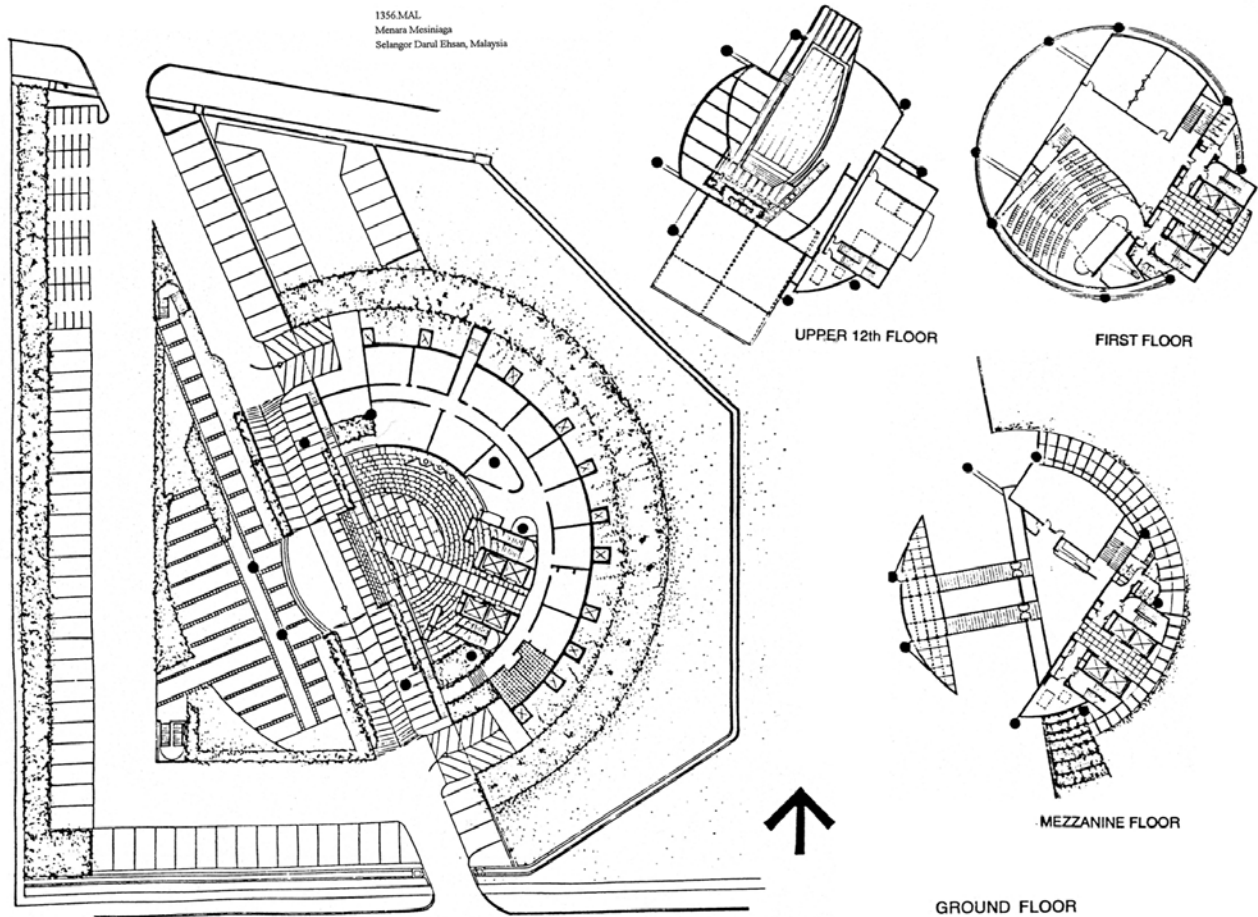

1356.MAL
Menara Mesiniaga
Selangor Darul Ehsan, Malaysia

UPPER 12th FLOOR

FIRST FLOOR

MEZZANINE FLOOR

GROUND FLOOR